

# Sapporo Science Center Visitor Guide

## Welcome to Sapporo Science Center!

Sapporo Science Center contains Exhibition Rooms, where visitors can experience the workings of science, as well as our Planetarium, which provides breathtakingly beautiful views of the starry skies.

Please enjoy your visit.



# Sapporo Science Center

3F

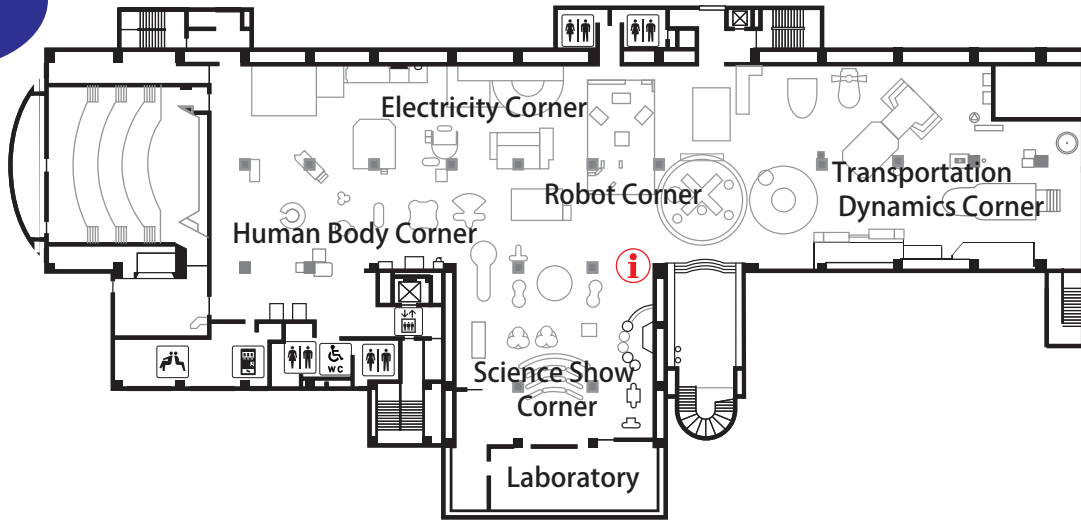

2F

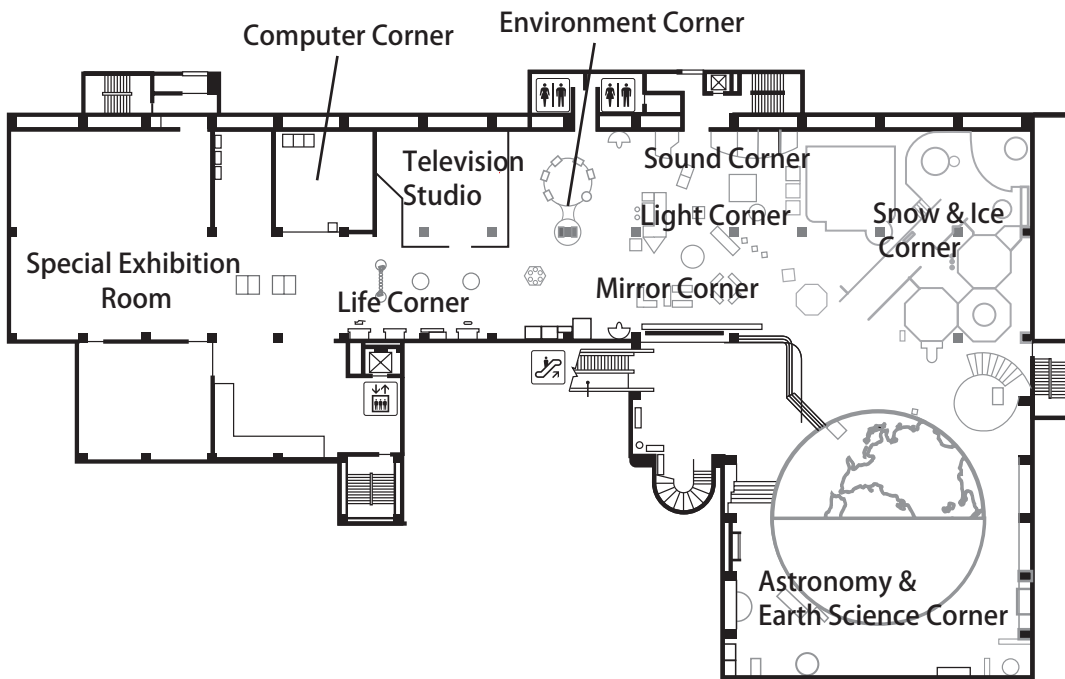

1F

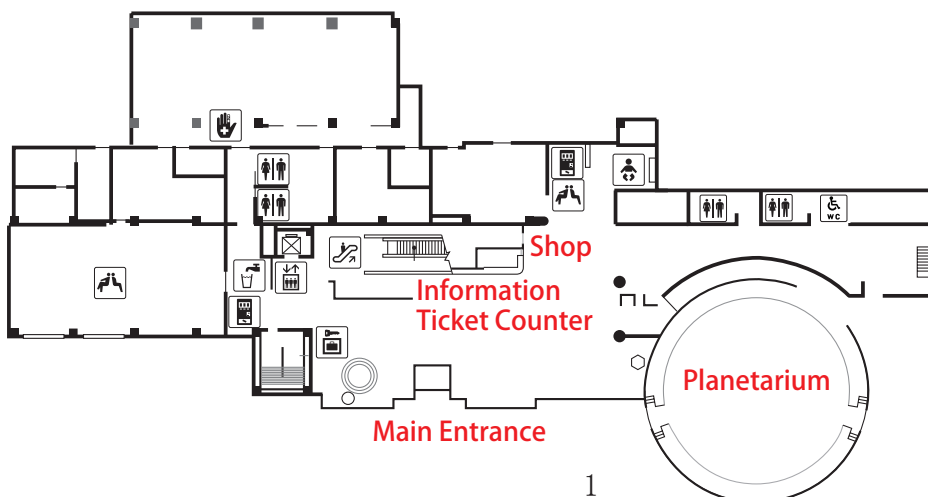

- Information
- Washroom
- Multipurpose Washroom
- Nursery
- Break Room
- Vending Machine
- Drinking Water Fountain
- First Aid Room
- Coin Lockers
- Elevator
- Escalator



## ■About our Exhibition Rooms

- We have about 200 exhibits, ranging from large to small.
- In addition to viewing, most of the exhibits may be touched or moved to better appreciate them.
- We invite visitors to learn about the principles of science through hands-on interaction.
- Photography is allowed throughout the Exhibition Rooms.



## Main Exhibits

### Astronomy & Earth Science Corner 2nd Floor

- Entering this Exhibition Room, visitors are greeted by a large dome representing winter in the northern hemisphere.
- Moving around the perimeter of the dome, visitors will embark on a journey from the origins of the cosmos to the inside Earth.

○Touchable Earth: This digital earth globe is controlled by touch.

### Snow & Ice Corner 2nd Floor

- Sapporo is a very snowy city, with yearly cumulative snowfalls in excess of 5 meters.
- This corner offers comprehensive information about snow and ice.

#### ○Artificial Snowfall Device

This device causes artificial snow to fall by re-creating the environmental conditions of natural snowfall.

#### ○Snow Design Laboratory

Visitors design snow crystal shapes which change with temperature and humidity, all the while learning about the mechanism of snow crystals.

## Dynamics Corner 3rd Floor

- Use handles and air pumps to lift balls styled after Newton's apple, and let the balls fall and roll to learn about the nature of objects in motion.

## Naoko Yamazaki Astronaut Corner 3rd Floor

- Exhibits include panels introducing the life in space of Naoko Yamazaki, an astronaut and the honorary director of Sapporo Science Center, as well as actual items she brought into space, clothing she wore in space, and more.

## ■ Exhibition Room Shows & Performances

- The Exhibition Rooms are venues for a wide variety of shows and performances.
- All programs are presented in Japanese.
- Participation is free of charge.



			Weekday	Weekend, Holiday & Special Exhibition Period
2nd Floor	Television Studio	A live show featuring special photography experiments.(20 minutes)	from 10:30 from 14:15	from 10:30 from 14:15 from 15:30
	Low-Temperature Exhibition Room	Phenomena such as icicles and ice floes exhibited in -10°C(14° F) room.	11:45 to 12:00 13:45 to 14:00 15:45 to 16:00	10:15 to 10:30 11:45 to 12:00 15:45 to 16:00
	Artificial Snowfall Device	Use an artificial snowfall device to create snowfall.	from 10:00 / from 14:45	from 11:30 / from 16:00
3rd Floor	Science Show	An experiment show for all ages. (15 minutes)	from 9:45 (May to Sep) from 11:00 from 15:00	from 11:00 from 13:00 from 15:00
	Robot Show	A show presented by human-shaped robots. (7 minutes)	from 11:30 from 13:30	
	Sunday Laboratory	Experimental classroom oriented for children of elementary and junior high age. (40 minutes)		from 14:00 (Registration 13:30 to 13:50) Maximum 32 participants

## ■About our Planetarium

- Sapporo Science Center Planetarium features an 18-meter diameter dome and seating for 200. Renovated in April 2016 to top international standards, the equipment is capable of projecting about 100 million stars.
- The basic program features live explanation by our staff together with video contents such as computer graphics and animation, for a total of 50 minutes.
- There are also some 30-minute programs oriented for children.
- The programs change monthly.
- Programs are presented in Japanese.
- Eating and drinking is not permitted in Planetarium.
- Planetarium presentations are rotated each time. Admission tickets are required, and are designated by presentation time.
- After purchase, admission tickets may not be refunded or changed to a different time.
- Ticket sales close 5 minutes after opening time, and presentations commence 10 minutes after opening time.
- Entry and exit are not allowed during presentations.
- "Weekend & Holiday" refers to Saturdays, Sundays, public holidays, and special exhibition periods.

### 【May – September】

	1st Presentation	2nd Presentation	3rd Presentation	4th Presentation	5th Presentation	6th Presentation
Weekdays	9:10 (Groups Only)	10:25 (Group Priority)	11:40 (Group Priority)	13:00	14:15	15:30
Weekend & Holiday	9:40	10:50	12:00	13:15	14:30	15:45

### 【October – April】

	1st Presentation	2nd Presentation	3rd Presentation	4th Presentation	5th Presentation	6th Presentation
Weekdays	10:50 (Groups Only)	11:30 (Group Priority)	12:45 (Group Priority)	14:00	15:15	—
Weekend & Holiday	10:15	11:30	12:45	14:00	15:15	—

- On weekday mornings, programs for elementary students may be substituted without advance notice. We ask for your kind understanding.
- Visitors are not allowed to view presentations while their children are seated on baby strollers.

- With safety in mind, we ask that small children sit on a guardian's lap.
- Photography, video, and audio recording are not permitted during presentations.

## ■ About our Facilities

### Admission Ticket Counter 1st Floor

- Admission Ticket Sales
- Baby Stroller & Wheelchair Lending Service
- Lost & Found, Lost Children

### Break Corners 1st & 3rd Floors

- Snack and ice cream vending machines are on the 1st floor.
- Drink vending machines are on the 1st and 3rd floors.
- Eating and drinking is not permitted outside of the break corners.
- Sapporo Science Center and its grounds are entirely non-smoking.
- Sapporo Science Center does not contain any restaurants. For dining, please visit the nearby commercial buildings.

(Visitors may re-enter Exhibition Rooms on the same day as their admission ticket purchase.)

### Shop 1st Floor

- The 1st floor shop offers a wide variety of products, including Sapporo Science Center original goods.

Planisphere "Sapporo" Version

Astronaut Food: a variety of freeze-dried foods.

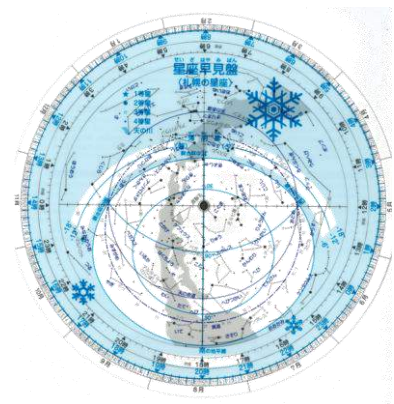

## ■ Visitor Information

### Hours

May - September: 9:00 am to 5:00 pm

October - April: 9:30 am to 4:30 pm

Last admission is 30 minutes prior to closure.

### Closures

- Every Monday (open when Monday falls on a public holiday), the last Tuesday of each month, the day following a public holiday, the day following the last day of a special exhibition, and December 27th to January 4th.
- Open every day during Golden Week period or special exhibition periods.

### Admission Fees

- Children aged 15 and under are admitted free of charge.
- Please enter after receiving your ticket from the Admission Ticket Counter.

Category		Adult	Discounted Visitors	Child	
Individual	Exhibition Rooms	700 yen	500 yen	Free of Charge (Junior High School Student or Under)	
	Planetarium	500 yen	360 yen		
	Value Ticket (Set of 5 Tickets)	Exhibition Rooms	3,150 yen	—	—
		Planetarium	2,250 yen	—	
	Set Admission Ticket (Exhibition Rooms and Planetarium)		1,000 yen	860yen	
Package Ticket (Exhibition Rooms, Planetarium, and Sunpiazza Aquarium)		1,750 yen	—		
Group *	Exhibition Rooms	630 yen	500 yen	Free of Charge (Junior High School Student or Under)	
	Planetarium	450 yen	360 yen		

\* Group rates apply for 30 or more adults.

A "Group" refers to a group of 30 or more adults.

Please inquire for further details.

## Transportation & Access

- Subway Tozai Line: Take Exit #1 from Shin-Sapporo Station, and proceed straight ahead.
- JR Chitose Line: About 5 minutes on foot from Shin-Sapporo Station, via Sunpiazza

## Parking Lots

### ○Sapporo Science Center Parking Lot (Free of Charge)

- Only available on weekends, public holidays, and during special exhibitions.
- At times other than indicated above, these parking lots are designated for group buses only.

### ○Nearby Arc City Parking Lot

- Receive a stamp at the 1st floor Information Counter to receive 2 hours free parking. Valid for Sunpiazza Duo, North, East, and South parking lots. (Hours vary for each parking lot.)

## Sapporo Science Center

Tel : 011-892-5001

2-20, 1-jo 5-chome, Atsubetsu Chuo, Atsubetsu-ku, Sapporo Postal Code: 004-0051